

HANDSHOWER

WATER EFFICIENT TAPWARE

(NOMINAL FLOW RATE = 9 L/min)

PLUMBERS INSTALLATION INSTRUCTIONS

Important Information

- * Wall elbow (6) is fitted with a 9 L/min flow regulated check valve (9).
- Note: warranty is void if check valve (8) & flow regulated check valve (9) are not installed as shown.
- * Not suitable for gravity feed systems.
- * All pipework must be thoroughly flushed prior to installation, as foreign materials may block the flow regulating device and reduce the flow of water.
- * Threaded nipple (1) must be square to Wall/Tile face to ensure correct installation.
- * To prevent drill from wandering on tiled surface it is recommended that masking tape be applied prior to drilling the tiled surface. Mark out the centres ensuring the centres are horizontal.
- * Turn off hot and cold water supplies before installation.

Installation

- 1) Check that threaded nipple (1) is the correct length, as shown. Cut to length if required ensuring end face is square. Apply thread tape to the thread.
Important: Care must be taken that thread tape cannot become dislodged and block the flow regulating device, causing a reduction in water flow.
- 2) Slide brass washer (3) followed by cover plate (2) onto plain diameter of adaptor (4), as shown. Screw adaptor (4) onto threaded nipple (1) until cover plate (2) is held securely against wall/tile face and its top/bottom edge is horizontal, as shown in Fig. 2. **DO NOT OVERTIGHTEN.** Apply suitable lubricant to 'O'Rings (5) on adaptor (4).
- 3) Fit wall elbow (6) onto spigot of adaptor (4) and position base of wall elbow against the cover plate (2), taking care not to damage the decorative finish. While the wall elbow is held in the correct position against the cover plate, tighten screws (7) using 2.50mm allen key (13) until the wall elbow base (6) is held firmly against the cover plate (2).
- 4) Determine a position for the handshower holder (17), ensuring it is at a suitable height for all users. Using the mounting plug (18) as a template, mark out the holes for drilling.
(Note: The holes in the mounting plug (18) must be horizontal and the flat must be at the bottom.)

SOLID WALLS: – (Brick, masonry blocks, concrete etc)

- i) Drill holes 6.00mm diameter, 40mm deep.
- ii) Insert tapered end of wall plugs (20) into drilled holes and tap until flush with surface.

CAVITY WALLS: – (Villaboard/tile etc)

- i) Drill holes 6.00mm diameter.
- ii) Insert tapered end of wall plugs (20) into drilled holes and tap until flush with surface.

- 5) Place both screws (19) through the holes of the mounting plug (18), check that the flat is at the bottom, then tighten screws into installed wall plugs. Fit handshower holder (17) onto mounting plug (18) and tighten screw (21) using 3mm allen key (22).
- 6) Ensure that check valve (8), flow regulated check valve (9) and 'O' ring (10) are in position in the wall elbow. Ensure rubber washer (11) is in place in the hexagon nut on the shower hose (12), then screw onto wall elbow (6) and tighten. Ensure rubber washer (15) is in position in the conical fitting (14) on the shower hose (12). Screw the conical fitting (14) onto handshower (16) and tighten. Fit handshower into handshower holder. **Important:** If water does not flow from the handshower (16) make sure that check valves (8 & 9) are installed with the arrows pointing in the direction of flow.

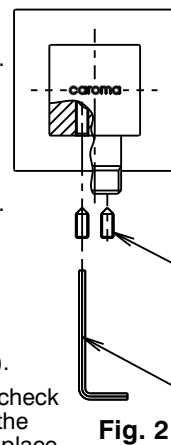

Fig. 2

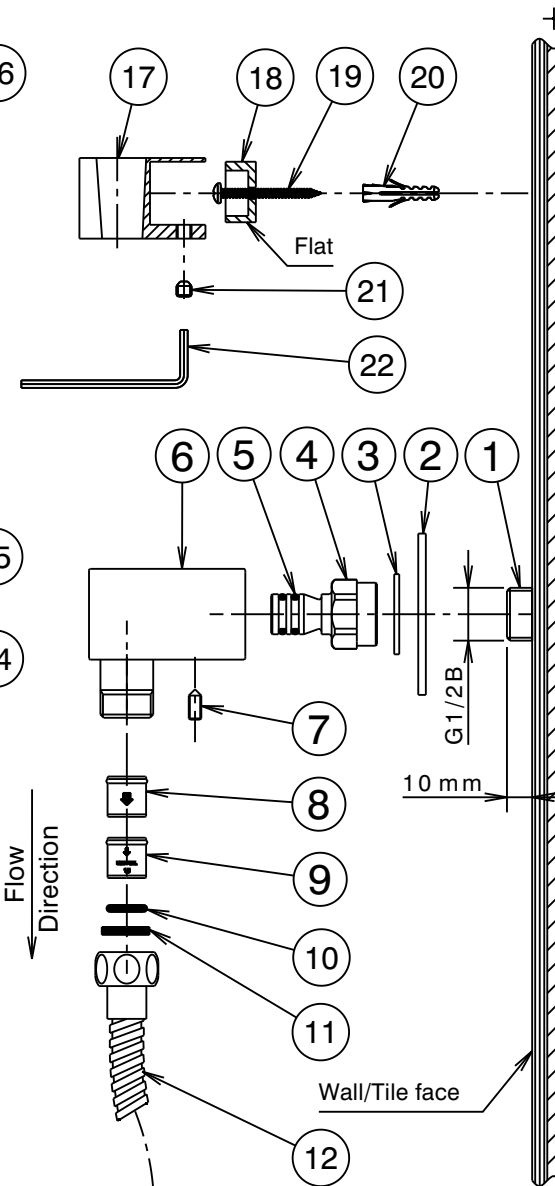

Fig. 1

IMPORTANT

Pressure & Temperature Requirements.

- Hot and cold water inlet pressures should be equal.
- Inlet pressure range : 150 – 1000 kPa
New Regulation : –500 kPa maximum operating pressure at any outlet within a building.
(Ref. AS/NZS 3500.1 – 2003, Clause 3.3.4)
- Maximum hot water temperature : 80°C.