

# User Guide

## Sparq S4

Sparkling, Chilled & Still Water System



**WaterMark**

WMTS 105

Certificate No. 23291

Australian Certification  
Services

**What's Inside**

Puretec Customer Service .....	3
Installation Record .....	3
Before Installation.....	4
Parts Included.....	4
Specifications.....	5
Dimensions.....	5
Tap Button Identification .....	6
Installation Procedure .....	8
How To Use Quick Connect Fittings.....	10
How To Operate The Tap .....	12
Filter Maintenance .....	12
Gas Replacement.....	13
Troubleshooting.....	14
Warranty.....	15

**AUSTRALIA**

Customer Service: 1300 140 140  
Email: [sales@puretec.com.au](mailto:sales@puretec.com.au)  
Web: [www.puretec.com.au](http://www.puretec.com.au)

**NEW ZEALAND**

Customer Service: 0800 130 140  
Email: [sales@puretec.co.nz](mailto:sales@puretec.co.nz)  
Web: [www.puretec.co.nz](http://www.puretec.co.nz)

## Puretec Customer Service

Thank you for purchasing a Puretec Sparq S4 Drinking Water Appliance. The Sparq S4 is a proven performer manufactured from only quality materials and components. It will give years of reliability and trouble-free operation if maintained properly.

**Caution: Do not use with water that is microbiologically unsafe or without adequate disinfection before or after the system.**

The Puretec Sparq S4 is designed for metropolitan supply water only.

Puretec Drinking Water Appliances are designed to run economically for many years and this is dependent on the initial installation and periodic maintenance.

Flush system for 5 minutes or more, after any period of non-use, more than 2 weeks.

**Note: Where maximum line pressure exceeds 500 kPa, the supplied multivalve must be installed to comply with Australian Plumbing Standards.**

## Installation Record

For future reference, fill in the following data:

PRODUCT INFORMATION	
Model Number:	<b>SPARQ-S4</b>
Serial / Batch Number: (Refer to label on the rear of the unit)	
Purchased From:	
Date of Installation:	
Installer / Plumber Details:	

All installation and service work should be completed by qualified tradespeople. Faulty operation due to unqualified persons will result in voided warranty.

All plumbing must comply with AS 3500.1 and AS3500.2.15.

## Before Installation

Read the instructions and check if there is adequate space to mount all of the components.

Check the mains water pressure is between 172 - 500kPa.

**NOTE: This product must be connected to MAINS WATER ONLY.**

Check the appliance rating plate and ensure correct power is available for the appliance.

Check the under counter cupboard supporting the appliance is adequate for the total net weight of 24kg (including the gas bottle).

**IMPORTANT NOTE:** Ensure there is adequate ventilation available through the cupboard. If there is inadequate ventilation, and the cupboard temperature rises to above 40°C, the system may become damaged and malfunction which will void the product warranty. To ensure there is sufficient cross-flow ventilation suitable holes or vents will need to be cut into the cupboard and door.

## Parts Included

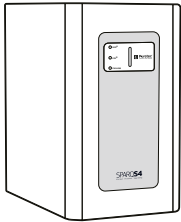

Sparq Unit

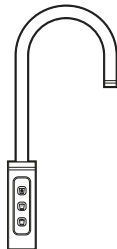

Faucet/Tap



CO<sub>2</sub> Bottle

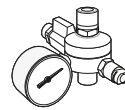

Regulator



SmartTee™

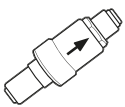

Multivalve



Straight  
Connector



Wiring Loom



Tubing



Power Cord



Spacer

## Specifications

Model:	<b>SPARQ-S4</b>
Throughput L/hour:	<b>20</b>
Chilled Temperature:	<b>4°C to 10°C</b>
Power Requirements:	<b>50Hz / 220~240 V</b>
Max Power Consumption:	<b>100 W</b>
Tap Dimensions:	<b>423 (H) x 205 mm (W)</b>
Appliance Dimensions:	<b>390 (H) x 81 (W) x 105 (D) mm</b>
Warranty:	<b>1 year<sup>^</sup></b>

## Dimensions

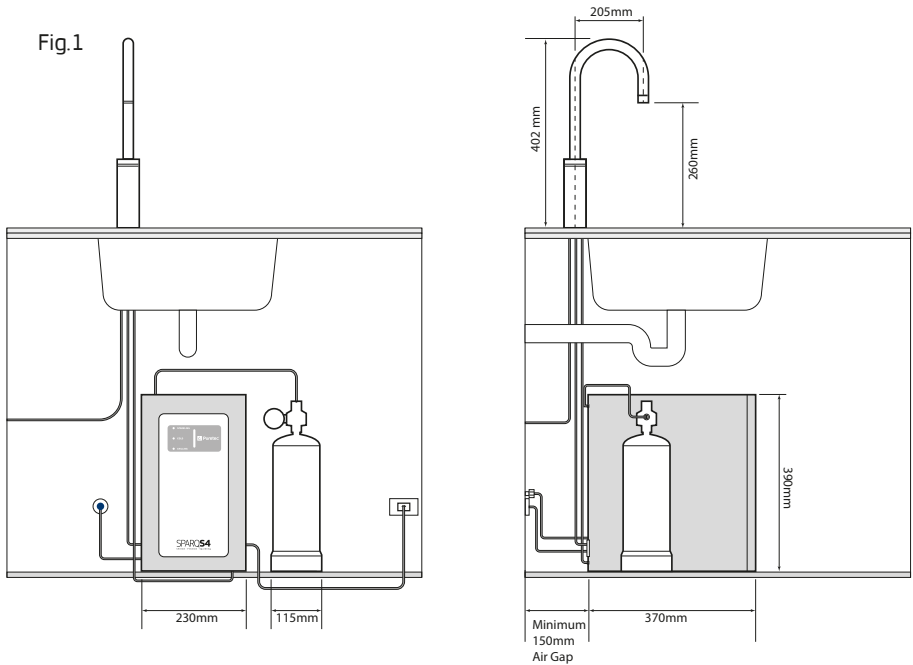

A Ø26mm hole is required for faucet (Max. 30mm).

<sup>^</sup>Warranty cover parts and labour for the period of 1 year where applicable subject to approval.

**Figure 1 - Tap Button Identification**

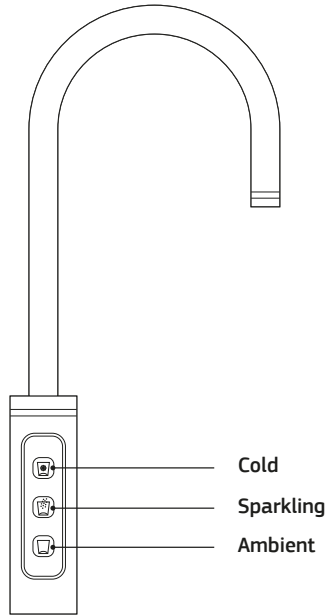

**Figure 2 - CO<sub>2</sub> Bottle**

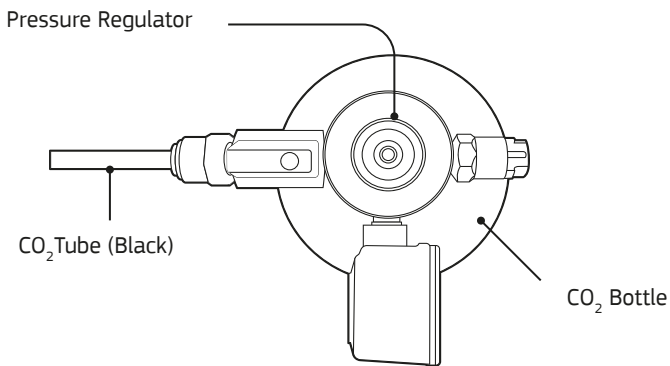

**Figure 3 - Exploded Diagram**

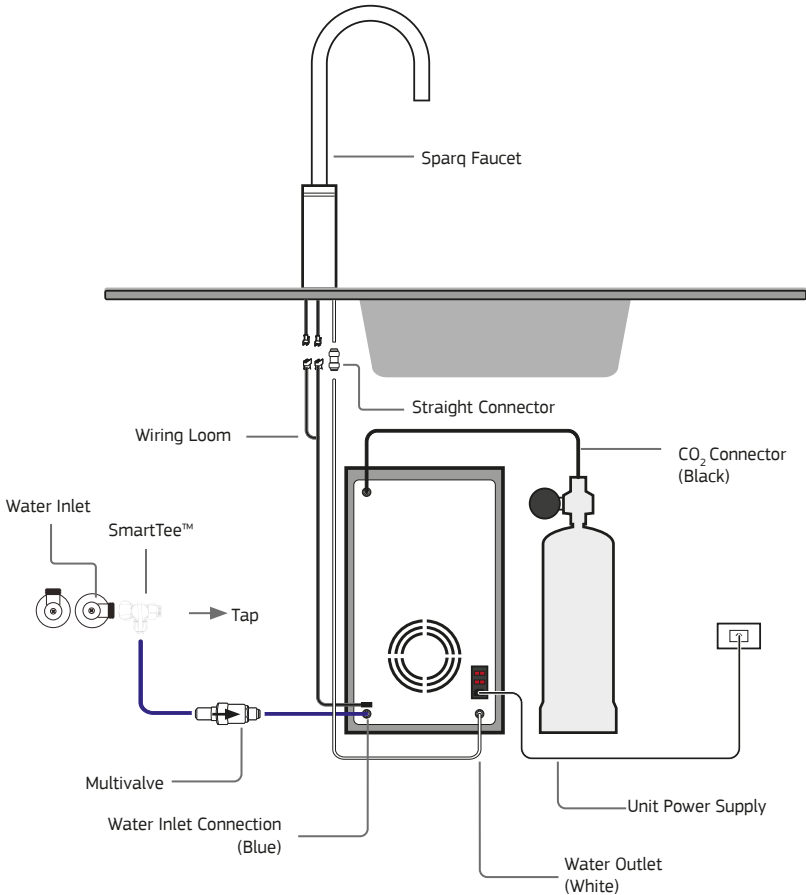

**Note:** All lines are 1/4" tube.

## Installation Procedure

**VERY IMPORTANT!** These installation steps are VERY important and must be followed in the correct sequence. Remove all packaging before installation including tubes on the back of the unit (see Fig. 4 for how to remove tubes).

**Installation Note:** A water filter system/tap, like any product, has a limited life and may eventually fail. Also sometimes failure happens early due to unforeseen circumstances. To avoid possible property damage, this product should be regularly examined for leakage and/or deterioration and replaced when necessary. A drain pan, plumbed to an appropriate drain or outfitted with a leak detector, should be used in those applications where any leakage could cause property damage, and/or the water supply should be turned off if no one is home/present.

1. Select a suitable position for the tap so that it dispenses into the sink bowl with ample clearance below the outlet and drill a 26 mm hole (max 30 mm).
2. Isolate water supply. Uninstall the connections on the cold water line and connect the SmartTee™ (see Fig. 5). Reinstall the previous connection to the tee valve.
3. Connect the Multivalve to the SmartTee™ with a length of BLUE tubing. Please see Fig. 3 for water flow direction.
4. Connect the Straight Connector to the White Tube connected to the tap (see Fig.3).
5. Remove the black plastic nut from the tap thread and connect the Wiring Loom to the tap (see Fig.3).
6. Feed the Straight Adaptor and Wiring Loom through the tap hole and place tap into position.
7. Screw the tap nut and tighten making sure the tap is correctly positioned on top. Fixing the tap to a sink may require more care to align all parts.  
**Note:** For thin bench tops or a sink mount, use the supplied spacer, slipping it up the thread, followed by the black nut to tighten.
8. Choose the best position for the unit with required 150 mm clearance for ventilation to the rear and top of the unit. Remember to allow access room for changing filters and a suitable place where water spillage will not cause damage.
9. With a length of BLUE tubing (enough length to pull out of the cupboard to change filters if not enough height), connect the Multivalve to the inlet at the back of the unit (see Fig. 3). **Note:** If cupboard space does not permit enough space for filter changes, leave enough tube length to allow the filter system to come out of the cupboard to change the filters.
10. With a length of WHITE tubing, connect the straight adaptor to the water outlet.
11. Attach the Wiring Loom from the tap to the unit (see Fig. 3).



12. Connect the power cord (**DO NOT TURN POWER ON**).

**DO NOT** turn on the water/and or power supply, this will be done in Step 22-26 of Cold/Ambient Water Startup on Page 10.

13. Position the CO<sub>2</sub> bottle as close to the unit as possible, ensuring the bottle is upright.

**NOTE: Bottles should always be upright during storage and transit. If the bottle has been left horizontal, place upright and let stand for 60 minutes for contents to settle before initialising.**

**The SPARQ-CO<sub>2</sub> is NOT refillable.**

14. Ensure regulator is off by turning the shut-off valve into the closed position.
15. Connect the CO<sub>2</sub> bottle to the regulator. Screw the regulator on firmly (warning: some CO<sub>2</sub> will escape as the valve in the bottle is depressed).
16. Attach the BLACK tube to the CO<sub>2</sub> connection at the back of the unit and CO<sub>2</sub> bottle (See Fig.2).

**DO NOT** open the regulator, this will be done in Step 27 of Soda/Sparkling Water Startup on page 11.

17. Double check all tubes have been connected properly.
18. Check all plumbing fittings have been tightened and all tubing is connected firmly.

## Figure 4 - How To Use Quick Connect Fittings



1. Cut the tube square and push in to the tube stop. For metal tube remove burrs and chamfer tube end to prevent O-Ring seal being damaged.

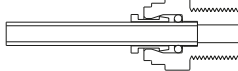

3. Tube is secured in position.

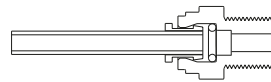

2. Fitting grips before it seals. Ensure tube is pushed in to tube stop.

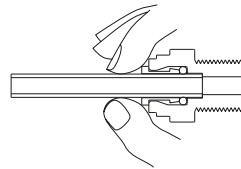

- DISCONNECTION PROCEDURE**
4. Push collet against body and slide tube out of fitting.

19. Ensure there is adequate ventilation around the unit (150 mm).
20. Check all tubes from the undersink unit to the tap, ensure there are no sags or kinks in the hoses, and any tube sag is minimised as it can cause flow to be reduced.
21. Check all electrical connections are correct and there are no loose wires.

## **COLD/AMBIENT WATER**

22. Turn on the water and check for leaks.
23. Allow tank to fill for 5 minutes.
24. Turn on the power supply at the power point - tap should light up and after a minute all lights on the tap will be blue.
25. Flush the filters by pressing on the cold button on the tap first for 1 minute and followed by the ambient button for another minute (it is normal for black fines, cloudiness or micro-bubbles to come through). To activate water flow, press the button once and the ring light on the top goes green, then press the button again for water flow.
26. Turn on the COLD power switch on the back of the chiller. The chilling indicator on the front panel of the unit will turn off once the correct temperature is reached. The temperature is preset to 4-10 degrees. It takes up to 20 minutes.

## **SODA/SPARKING WATER**

27. Ensure CO<sub>2</sub> bottle is connected firmly to the regulator and the gas tube is fitted.
28. Turn on the SODA power switch on the back of the chiller.
29. Open the regulator valve.
30. Turn off the water supply at the inlet (Smart Tee™ valve).
31. Purge the Soda line for 1-2 minutes by pressing on the Sparkling Button on the tap until the water flow stops and only CO<sub>2</sub> comes out.
32. Restore the water supply and allow 1-2 minutes for the lines to refill.
33. Operate the Sparkling Button on the tap (approx. 15 sec.) until excess CO<sub>2</sub> excess has been dispensed.
34. Your Puretec system is now ready for use. It may require an hour or two for the sparkling water to reach full "fizz".

**NOTE: A small amount of water will come out after using the Sparkling feature for 1-2 seconds. This is normal as the CO<sub>2</sub> is purged from the line.**

## Figure 5 - SmartTee™ Quick Connect Fitting

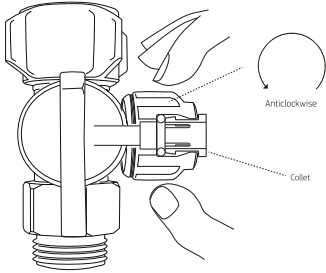

1. Turn the quick connect nut on the SmartTee™ anticlockwise to release the collet.

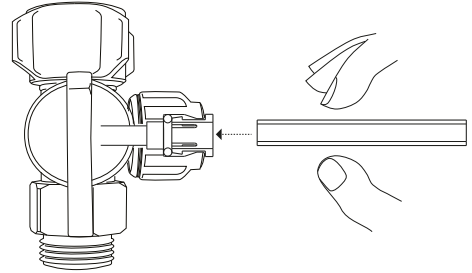

2. Cut the tube square and push into into the tube stop (inside the collet). For metal tube; remove burrs and chamfer tube end to prevent O-ring seal being damaged.

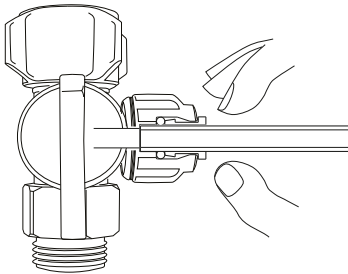

3. The fitting grips before it seals. Ensure the tube is pushed all the way into the tube stop.

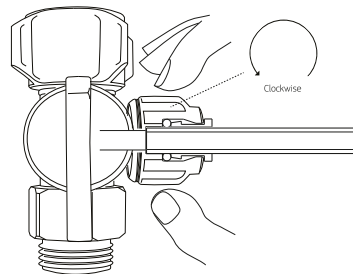

4. Once the tube is secured in position, turn the quick connect nut clockwise to secure.  
Note: Hand tighten only. Do not overtighten.

### DISCONNECTION PROCEDURE

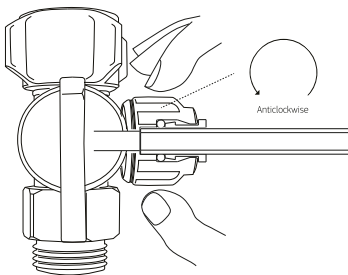

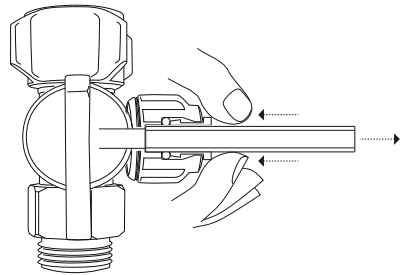

5. Turn the quick connect nut on the SmartTee™ anticlockwise to release the collet.



6. Push the collet against the quick connect nut and slide tube out of fitting.

## How To Operate The Tap

When the BLUE light is on, the tap is in 'Sleep Mode'. Press the desired button once and the LED light will change from Blue to Green to indicate that the tap is ready. Press the button again to start dispensing water.

1. Push the  button (top) for cold water.
2. Push the  button (middle) for sparkling water.
3. Push the  button (bottom) for ambient water.

## Filter Maintenance - Every 12 Months or When Taste Returns

1. Turn off ball valve and purge lines by pressing tap on until flow stops.
2. Remove filter cover by pushing the clip in.
3. Remove filter manifold pushing in the button to unclip.
4. Unscrew old filters from the manifold.
5. Clean inside manifold (wipe down) so there is no excess water.
6. Screw in new filters.
7. Reinsert manifold ensuring it is clipped in properly.
8. Restore water supply checking that there is no water leaks.
9. Reinstall the filter cover.
10. Flush the filters for 10 minutes by operating the ambient water button firstly for 3 minutes and then the chilled water button for 3 minutes or until black carbon fines have cleared. It is usual for there to be black carbon fines and/or white cloudiness initially, however these will clear up.

### **Gas Replacement - As Required**

1. Close regulator, turn off soda button and water supply.
2. Purge sparking lines by pressing the sparking button for 30 sec.
3. Disconnect regulator from BLACK tubing.
4. Unscrew the regulator from CO<sub>2</sub> bottle (turn the regulator anti-clockwise).
5. Connect regulator to new CO<sub>2</sub> bottle (turn the regulator clockwise).
6. Connect BLACK tubing to regulator.
7. Open the regulator and turn on the soda switch (at rear of the unit).
8. Purge the soda line for 1-2 minutes by operating the sparking/soda button on the tap until the water flow stops and only CO<sub>2</sub> comes out.
9. Restore the water supply and allow 1-2 minutes for the lines to refill.
10. Operate the sparkling water button on the tap for 30 seconds or until excess CO<sub>2</sub> has been dispensed.
11. Your Puretec system is now ready for use. It may require an hour or two for the sparkling water to reach full "fizz".

SYMPTOMS	POSSIBLE CAUSE	POSSIBLE SOLUTION
No cold water.	Cold temperature switch is off.	Please turn the cold temperature switch on.
	Refrigerant is low.	Call your service provider.
	Problem with compressor or thermostat.	Call your service provider.
No cold water from tap.	Ice blockage.	Please turn off the power supply and allow 24 hrs for the blockage to melt.
	No water inside the cold water tank.	Please check mains water supply.
Soda not working or flat.	CO <sub>2</sub> bottle is empty.	Replace CO <sub>2</sub> bottle.
	Soda power is off.	Turn on the soda power switch.
	CO <sub>2</sub> line needs purging.	Follow the instructions in changing the CO <sub>2</sub> bottle to purge the line.

## **WARRANTY**

Any claim under this warranty must be made within 1 year of the date of purchase of the product. This product is warranted to be free of defect of material and workmanship for 1 year from date of purchase. To make a claim under the warranty, take the product and proof of purchase to place where you purchased the product, and they will lodge a Warranty Request with Puretec. 1 year warranty is parts and labour. Excludes cartridges and canisters.

Puretec will pay your reasonable, direct expenses of claiming under this warranty. You may submit details and proof of your expense claim to place of purchase for consideration.

The warranty only applies if the product was used and/or installed in accordance with the user guide and/or installation instructions. This warranty is given in lieu of all other express or implied warranties and manufacturer shall in no circumstance be held liable for damages consequential or otherwise or delays caused or faulty manufacturing except as excluded by law.

Applicable to all above, is that the warranties need to be approved by Puretec to ensure product was not incorrectly used, installed or claimed. False and incorrect claims will be pursued at Puretec's discretion, including chargeable inspection and labour costs incurred.

## **WARRANTY / AUSTRALIA**

This warranty is given by Puretec Pty Ltd, ABN 44 164 806 688, 37-43 Brodie Road Lonsdale SA 5160, telephone no. 1300 140 140 and email at sales@puretec.com.au.

This warranty is provided in addition to other rights and remedies you have under law: Our goods come with guarantees which cannot be excluded under the Australian Consumer Law. You are entitled to replacement or refund for a major failure and to compensation for other reasonably foreseeable loss or damage. You are also entitled to have the goods repaired or replaced if the goods fail to be of acceptable quality and the failure does not amount to a major failure.

## **WARRANTY / NEW ZEALAND**

This warranty is given by Puretec Ltd, Reg. No 4464398, PO Box 875, Cambridge 3450, NZ, telephone no. 0800 130 140 and email at sales@puretec.co.nz.

This warranty is provided in addition to other rights and remedies you have under law: Our goods come with guarantees which cannot be excluded under the Consumer Guarantees Act. You are entitled to replacement or refund for a major failure and to compensation for other reasonably foreseeable loss or damage. You are also entitled to have the goods repaired or replaced if the goods fail to be of acceptable quality and the failure does not amount to a major failure.



**AUSTRALIA**

P 1300 140 140

E [sales@puretec.com.au](mailto:sales@puretec.com.au)

W [puretec.com.au](http://puretec.com.au)

**NEW ZEALAND**

P 0800 130 140

E [sales@puretec.co.nz](mailto:sales@puretec.co.nz)

W [puretec.co.nz](http://puretec.co.nz)

Puretec water care products are designed, manufactured and supported by Puretec Ltd the name you can trust for viable and proven water solutions. The complete range of Puretec products are developed, refined, made to meet and exceed stringent specifications for the worldwide market. All pictures and information are supplied as a guide only. Fittings not included. ^1 Year Platinum Protection applies to Puretec Systems when used in conjunction with a Puretec filter cartridge. Warranty excludes cartridges.

Important Note: Sales of products are subject to our Terms and Conditions which are available upon request. All specifications, information and photos are a guide only and are subject to change without notice. Please ring to confirm details. Warning: For correct operation of this appliance it is essential to observe manufacturer's instructions. Caution: Do not use with microbiologically unsafe water or water of unknown quality without adequate disinfection before or after the system. Under normal circumstances a pressure limiting valve is not required. However, if incoming water pressure exceeds 500 kPa, a pressure limiting valve must be fitted prior to inlet. Copyright © Puretec Ltd 2018

