

Oliveri®

THIS MIXER TAP MUST BE INSTALLED BY A LICENSED PLUMBER IN ACCORDANCE WITH LOCAL REGULATIONS

This Oliveri tap is manufactured to standard AS/NZS 3718.

This Oliveri shower rail is manufactured to standard AS/NZS 3662.

MAX OPERATING PRESSURE:.....5 bar (500kPa)
RECOMMENDED OPERATION PRESSURE:.....1.5-5 bar (150-500kPa)
MAX HOT WATER TEMPERATURE:.....65°C
RECOMMENDED HOT WATER TEMPERATURE:.....50°C

Where water pressure exceeds 500kPa, a pressure reducing device is required to be installed. Note that water pressure overnight can reach 150% of the daytime pressure.

Note: Ceramic Cartridges - Warranty claims will not be honoured where the ceramic cartridge has malfunctioned due to the presence in the water supply of;

- Copper tube pieces, sand, dirt or stones
- Thread tape
- Other objects not normally present in potable water supplies.
- Do not remove the cartridge from the body as it has been pressure tested and tightened to a specific torque.

Before attempting any work involving mains water supply lines, ensure the water supply is shut off.

This mixer tap must be installed in accordance with these instructions.

Oliveri®

PR288570CR/PR288586MB



Venice Floor Mounted Bath Filler

CARE & MAINTENANCE

Clean with a soft cloth and warm soapy water as necessary - rinse and dry after cleaning. Under No Circumstances should abrasive or acid based cleaning products be used.

WARRANTY

This mixer tap is warranted to be free from manufacturing defects for a period of 15 Years: 15 years for cartridge, 10 years for body, 5 years for seals, fittings and aerators, 2 years for plastic hand piece and shower hose, 1 year for finish and labour, when used in a domestic situation.

This warranty does not cover against normal wear and will be voided if the product is misused or not installed in accordance with these instructions. Note: Fitting spout-attached devices, including water filters, to this mixer will void warranty.

In the event this product is rendered obsolete and a replacement product is required, Oliveri Solutions Pty Ltd reserves the right to supply a product of equal substitution at their discretion.

Our goods come with guarantees that cannot be excluded under the Australian Consumer Law. You are entitled to a replacement or refund for a major failure and for compensation for any other reasonably foreseeable loss or damage. You are also entitled to have the goods repaired or replaced if the goods fail to be of acceptable quality and the failure does not amount to a major failure.

SERVICE

If the problem represents a danger, or damage to property may occur, immediately shut off the water supply.

If the product requires servicing, please contact your plumber / Installer (preferably the one who installed it).

If the Plumber / Installer is satisfied that the problem is not due to poor installation, contact T2 Services Pty Ltd for assistance on:

Ph: (07) 55960738

Fax: (07) 55273353

Email: oliveri@t2services.com.au

<https://oliveri.com.au/service-and-warranty>

If a warranty service agent finds that the mixer tap is not at fault, T2 Services Pty Ltd reserves the right to pass on any callout fee to the householder.

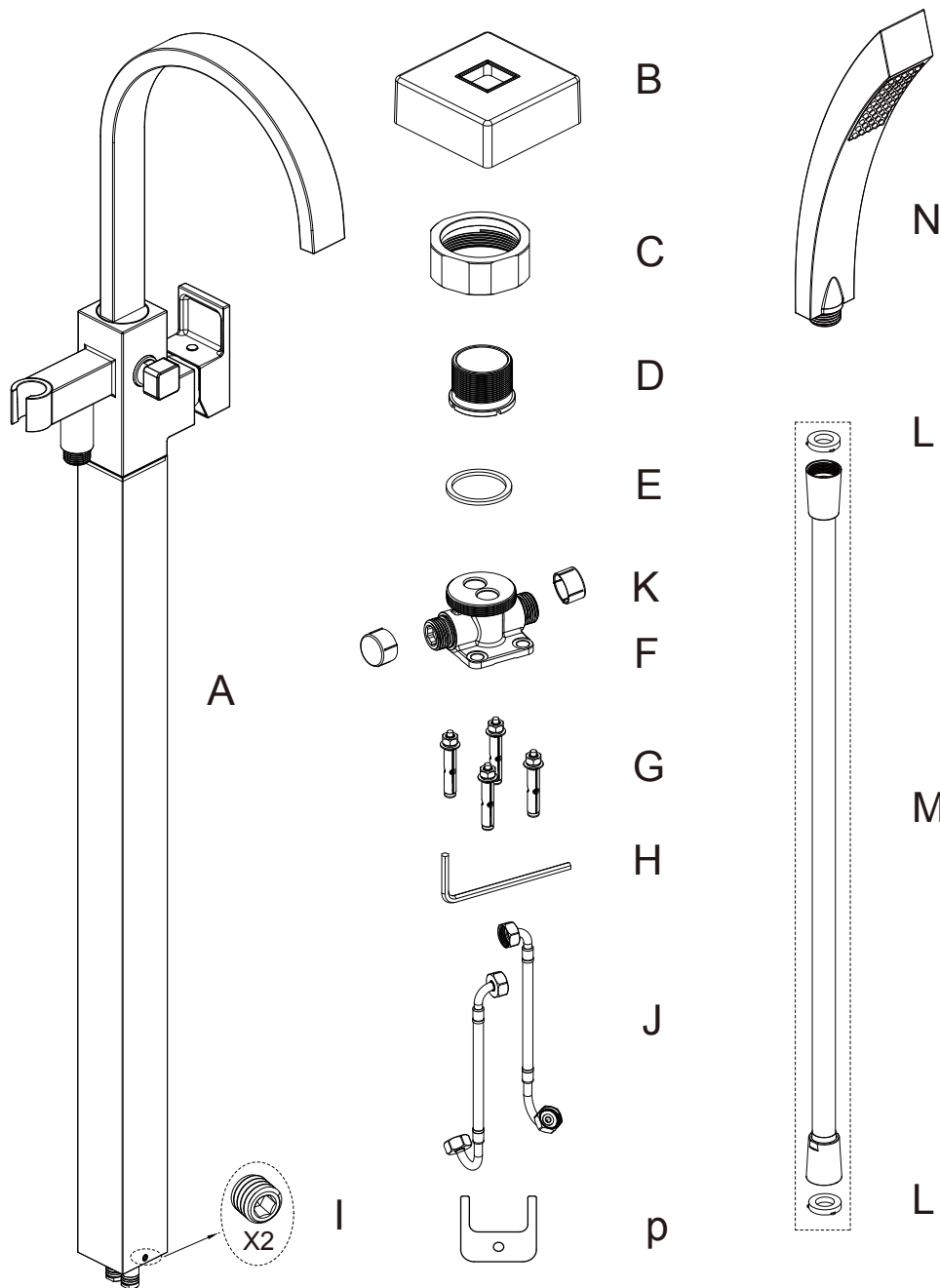

Oliveri®

Installation Instructions

General Note: This product is to be installed by a licensed plumber, installation must comply with AS/NZS 3500 and local plumbing codes.

Pressures & Temperatures

Maximum Hydrostatic Pressure – 500 kpa. (As per AS/NZS3500)

Note: AS/NZS 3500.1-2003 (Clause 3.3.4) states that “Provision shall be made to ensure that the maximum static pressure at any outlet, other than a fire service outlet, within a building does not exceed 500 kPa.

Note: Pressures above 500kPa can cause damage from water hammer, reduced life of appliances, taps and fittings, and cause excessive noise in the system.

Minimum Hydrostatic Pressure – 100 kpa

The Maximum operating temperature for the Mixer Tap is 65°C .

Please ensure that the lines are flushed prior to installation as contaminates in the water can damage the Ceramic Cartridge, flow regulator and also affect the performance of the Mixer.

1. Remove product from packaging and check for damages, if the product is damaged do not install and return to store of purchase.
2. Ensure Product is complete as per exploded drawing.
3. DO NOT Disassemble Body (A).
4. Prior to assembly, use diagram (8), (9) and (10) for positioning of copper pipes and mixer base in conjunction with the bath position.
5. Fit copper pipe ends with ½” BSP Tub Bushes as shown in Diagram (8).
6. Place Mixer Body (F) in position as per diagram (10) ensure Mixer Body (F) is within set out requirements to copper pipes, diagram (10).
7. Mark fastening hole position of mixer base.
 - Concrete Floor**, using a suitable drill and masonry drill bit, drill 8mm holes and use the Four Anchor bolts (G) supplied to secure mixer base to concrete floor, refer Diagram (1).
 - Timber type flooring**, due the variations of timber type floor materials screws are not supplied for this method of installation, using a suitable drill and drill bit for the floor material, drill holes and secure mixer base to floor using suitable screws.
8. Remove Inlet thread protection sleeves from the Mixer Body (F). Fit Stainless-steel mixer tails (J) to Copper tails and Mixer body (F), refer diagrams (4) and (10). **(DO NOT OVER TIGHTEN, TWIST OR KINK BRAIDED HOSE).**
9. Remove the two grub screws (I) from the base of the mixer tube assembly (A) using allen key (H) as per diagram (2).
10. Slide base cover (B) onto Mixer tube assembly (A).

N.B It is recommended you apply plumbers grade grease or soapy water to concealed o’ring in mixer base cover (B) for ease of sliding the base cover onto the mixer tube assembly (A). refer diagram (2).
11. Slide lock nut (C) onto mixer tube assembly (A). Screw threaded tube (D) into mixer tube assembly (A) until the flange on the threaded tube comes into contact with mixer tube assembly (A) and use special tool (P) to tighten. Refit Grub Screws (I) using allen key (H) into Mixer base (A) and tighten, refer diagram (3).
12. Using plumbers grade grease apply grease to inlet tube o’rings protruding from the mixer tube assembly (A). Place washer (E) on top of mixer base (E) refer diagram (5). Fit Mixer Tube assembly (A) to Mixer Base (F) ensuring inlet tubes on Mixer tube assembly (A) are aligned with the inlet holes on the Mixer base (F).
13. Screw mixer tube assembly (A) to mixer Base (F) using preassembled Lock Nut (C), tighten using suitable spanner. Slide Base Cover (B) over mixer base (F).

Aligning Spout to desired position

14. Once the Mixer is fully assembled to the floor, remove Grub screw as per diagram (6), rotate spout to desired position. Refit grub screw and tighten.

N.B - This Spout is not a free moving Swivel Spout and can only be repositioned by removing the grub screw, reposition the spout and refit grub screw and tighten.
15. Assemble Hand piece hose (M) to Mixer outlet and hand piece (N) ensuring sealing washers (L) are fitted to each end of Hand piece hose, refer diagrams (7) and (12).

To the consumer

1. The Mixer is to only be cleaned with warm soapy water
2. **Under No Circumstances** should any abrasive, cream or acid based cleaning agent be used as these types of cleaners will damage the chrome finish, Cartridge, seals and aerators.

