

Teo 1200

WALL HUNG BASIN INSTALLATION INSTRUCTIONS PLEASE READ CAREFULLY BEFORE INSTALLATION

IMPORTANT

Provide suitable reinforcement behind finished wall for the basin fixing at the fixing height position.

Roughing in for Fixing Kit :

For timber stud walls, noggins and studs must be positioned at a height to allow for the location of fasteners as detailed in **Figure 1**.

BASIN INSTALLATION WITH FIXING KIT

- 1- Mark fixing screw hole position on finished wall at the recommended height as detailed in **Figure 1**.
- 2- *For masonry wall installation:* Drill two Ø12mm holes for Expansion Fasteners.
For timber stud wall installation: Drill two Ø8mm holes for Fixing Screws.
- 3- Insert expansion fasteners into the drilled holes in masonry wall. The Fixing Screws, should be screwed into the wall using the flat section of the Fixing Screw, with a spanner as shown in **Figure 2**.
- 4- Locate basin onto the Fixing Screws on the wall. Insert Plastic Bushes, Metal Washers and fasten to wall with Fixing Nut to complete assembly as detailed in **Figure 3**.
- 5- Fit tap and waste assembly to the basin.
- 6- Tighten Fixing Nuts and connect plumbing to complete the installation.

All measurements are subject to accepted manufacturing tolerances. To ensure accuracy please check actual product dimensions before drilling for installation. The manufacturer reserves the right to change specifications at any time without giving prior notification. This product should be installed by a qualified plumber. Local authority, Water Board, and Building Regulations may apply to the installation of this product, and you should consult the appropriate bodies on these requirements.

Wall Hung Basin Basin Fixing Kit

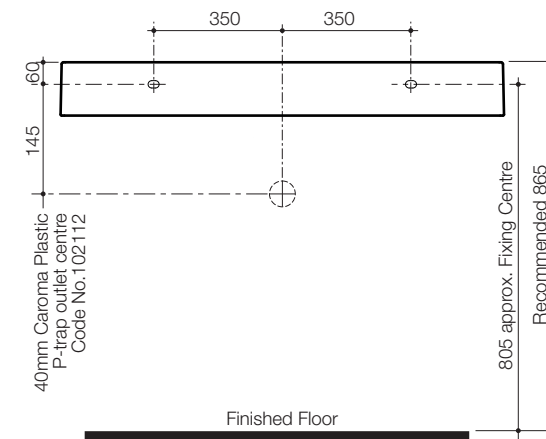
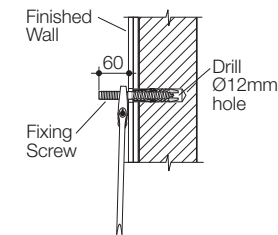

Figure 1

IMPORTANT:

Fixing Screw Masonry Walls Installation



Fixing Screw Timber Stud Walls Installation

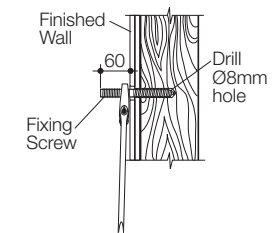

Figure 2

Basin Fixing Kit Completed Installation

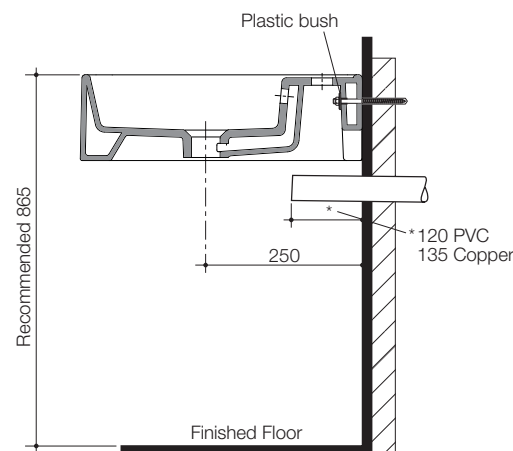

Figure 3

Basin Fixing Screw Kit

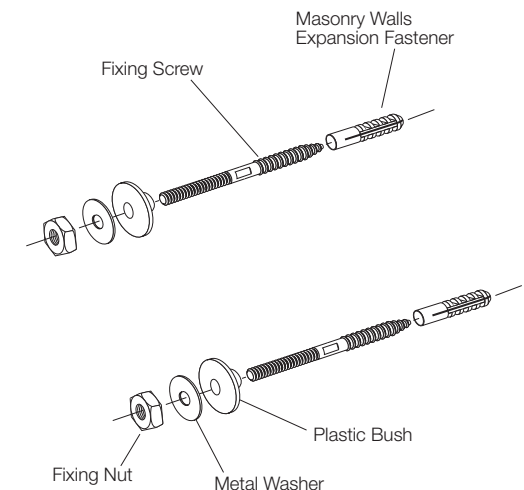

Figure 4